

Install screw: KA3\*12mm

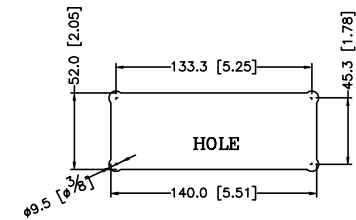
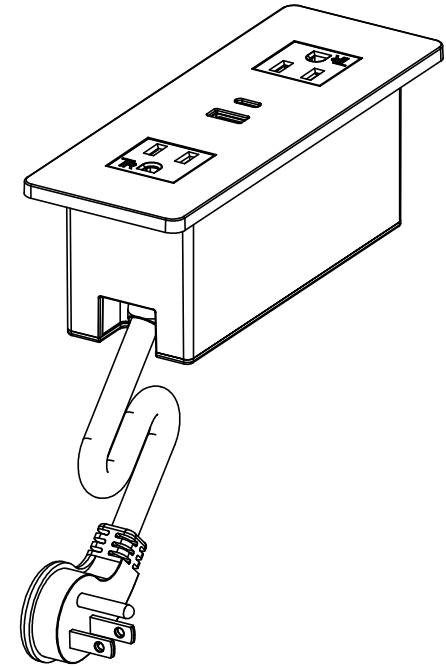

### Specifications:

- \* 2 Tamper Resistant outlets
- \* USB-A OUTPUT: 18W Max.  
USB-C OUTPUT: 66W Max.
- \* 10' SJT 14AWG\*3C Power cord
- \* Rating:125V 60HZ 15A

REV	DATE	DRAWN	APPROVED	DESCRIPTION																														
 www.MOD-PLS.com				<table border="1"> <tr> <th colspan="4">TOLERANCE (mm [INCH])</th> </tr> <tr> <td>[mm]</td> <td></td> <td>[INCH]</td> <td></td> </tr> <tr> <td>X</td> <td>±2.5</td> <td>XX</td> <td>±0.1</td> </tr> <tr> <td>XX</td> <td>±0.8</td> <td>XXX</td> <td>±0.03</td> </tr> <tr> <td>XXX</td> <td>±0.25</td> <td></td> <td>±0.010</td> </tr> <tr> <td>SCALE</td> <td>VIEW</td> <td>UNIT</td> <td>SHEET</td> <td>DRAWING#</td> </tr> <tr> <td>1:1</td> <td></td> <td>mm[INCH]</td> <td>1 OF 1</td> <td>C-DK1200250630003</td> </tr> </table>	TOLERANCE (mm [INCH])				[mm]		[INCH]		X	±2.5	XX	±0.1	XX	±0.8	XXX	±0.03	XXX	±0.25		±0.010	SCALE	VIEW	UNIT	SHEET	DRAWING#	1:1		mm[INCH]	1 OF 1	C-DK1200250630003
				TOLERANCE (mm [INCH])																														
				[mm]		[INCH]																												
				X	±2.5	XX	±0.1																											
				XX	±0.8	XXX	±0.03																											
XXX	±0.25		±0.010																															
SCALE	VIEW	UNIT	SHEET	DRAWING#																														
1:1		mm[INCH]	1 OF 1	C-DK1200250630003																														
DRAWN	YGY	DATE	Aug.10th 2025																															
CHECKED	JBX	DATE	Mar.27th 2027																															
APPROVED		DATE																																
PN	TV23100-153-M-66AC-TR(DOCK-1200-2+1-66AC)																																	
			REV																															
			Qb																															