

Install screw: KA3\*12mm

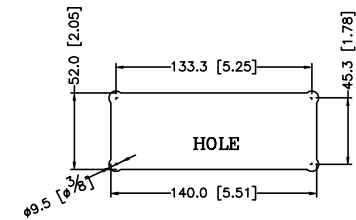

### Specifications:

- \* 2 Tamper Resistant outlets
- \* (x2) USB Type-C CHARGING PORTS, Total 66W Max.
- \* 10' SJT 14AWG\*3C Power cord
- \* Rating: 125V 60HZ 15A

REV	DATE	DRAWN	APPROVED	DESCRIPTION																																																				
				<table border="1"> <tr> <td colspan="4">TOLERANCE (mm [INCH])</td> <td>DRAWN</td> <td>YGY</td> <td>DATE</td> <td>Aug.10th 2025</td> </tr> <tr> <td>[mm]</td> <td></td> <td>[INCH]</td> <td>CHECKED</td> <td>JBX</td> <td>DATE</td> <td>Mar.27th 2027</td> </tr> <tr> <td>X ±2.5</td> <td></td> <td>XX ±0.1</td> <td>APPROVED</td> <td></td> <td>DATE</td> <td></td> </tr> <tr> <td>XX ±0.8</td> <td></td> <td>XXX ±0.03</td> <td>PN</td> <td>TV23100-153-M-66CC-TR(DOCK-1200-2+1-66CC)</td> <td></td> <td></td> </tr> <tr> <td>XXX ±0.25</td> <td></td> <td></td> <td></td> <td></td> <td></td> <td></td> </tr> <tr> <td>SCALE</td> <td>VIEW</td> <td>UNIT</td> <td>SHEET</td> <td colspan="2">DRAWING#</td> <td>REV</td> <td></td> </tr> <tr> <td>1:1</td> <td></td> <td>mm[INCH]</td> <td>1 OF 1</td> <td colspan="2">C-DK1200250630004</td> <td>Qb</td> <td></td> </tr> </table>	TOLERANCE (mm [INCH])				DRAWN	YGY	DATE	Aug.10th 2025	[mm]		[INCH]	CHECKED	JBX	DATE	Mar.27th 2027	X ±2.5		XX ±0.1	APPROVED		DATE		XX ±0.8		XXX ±0.03	PN	TV23100-153-M-66CC-TR(DOCK-1200-2+1-66CC)			XXX ±0.25							SCALE	VIEW	UNIT	SHEET	DRAWING#		REV		1:1		mm[INCH]	1 OF 1	C-DK1200250630004		Qb	
				TOLERANCE (mm [INCH])				DRAWN	YGY	DATE	Aug.10th 2025																																													
				[mm]		[INCH]	CHECKED	JBX	DATE	Mar.27th 2027																																														
				X ±2.5		XX ±0.1	APPROVED		DATE																																															
				XX ±0.8		XXX ±0.03	PN	TV23100-153-M-66CC-TR(DOCK-1200-2+1-66CC)																																																
XXX ±0.25																																																								
SCALE	VIEW	UNIT	SHEET	DRAWING#		REV																																																		
1:1		mm[INCH]	1 OF 1	C-DK1200250630004		Qb																																																		