



DOCK-1055 INSTALLATION INSTRUCTIONS

Model: DOCK-1055

Input: 125VAC 60Hz 15A

Output: (6) Tamper-Resistant AC
(1) USB Type-A Port: 18W
(1) USB Type-C Port: 45W

CAUTION:

To prevent the risk of fire and electric shock, please be sure to read all instructions before installing or using this unit.

WARNING:

To reduce the risk of fire, electric shock or injury to person:

- For indoor use only
- Do not use with extension cord(s)
- Do not plug a device or devices into receptacles that exceed a total of 15A (1800 watts)
- Do not open or attempt to open the unit for any reason

INSTALLATION:

- Turn the thumb screw on the mounting bracket counterclockwise to open the clamp. Using the thumb screw to adjust the width as it fits the thickness of the tabletop. The mounting bracket is compatible with tabletop thicknesses up to 2-1/2" (63.5mm).
- Slide mount onto the edge of work surface and turn the thumb screws clockwise until the bracket is fully secured.
- Plug the power cord into the nearest wall outlet. Do not use extension cord(s)

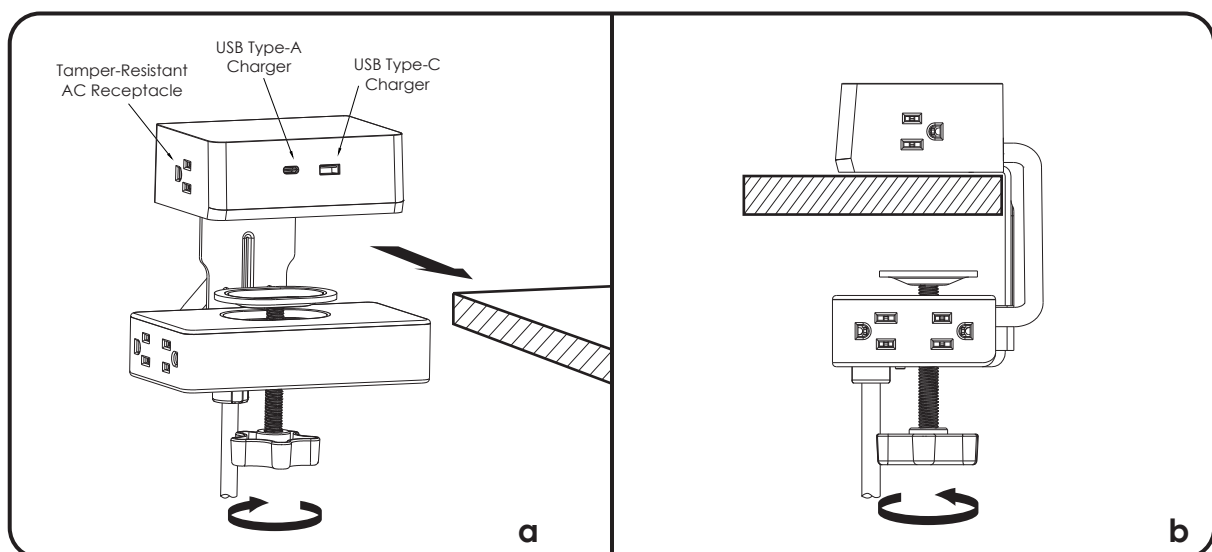

For further assistance, please contact National Lighting Corp. at +1(888) 428-6886