

DOCK-1075 INSTALLATION INSTRUCTIONS

Model: DOCK-1075

Input: 125VAC 60Hz 15A

Output: (6) Tamper-Resistant AC outlets

(1) USB Type-A Port: 18W

(2) USB Type-C Ports: 1 x 45W, 1 x 30W

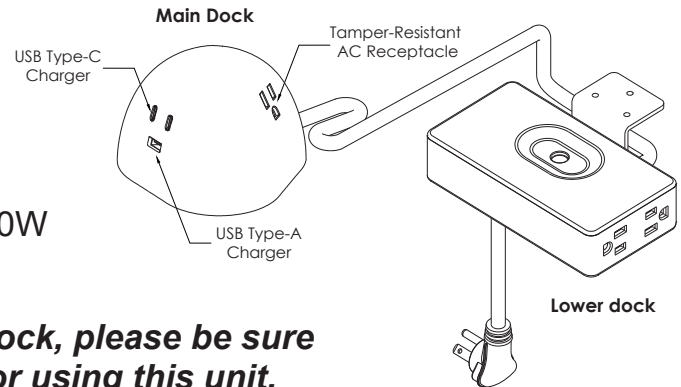

CAUTION:

To prevent the risk of fire and electric shock, please be sure to read all instructions before installing or using this unit.

WARNING:

To reduce the risk of fire, electric shock or injury to persons:

- For indoor use only
- Do not use with extension cord(s)
- Do not plug a device or devices into receptacles that exceed a total of 15A (1800 watts)
- Do not open or attempt to open the unit for any reason

INSTALLATION:

- a. Install the mounting plate onto the work surface using the self-tapping screws(included).
- b. Align the round positioning key on the mounting plate with the hole on the dock and press it down until it clicks into place.

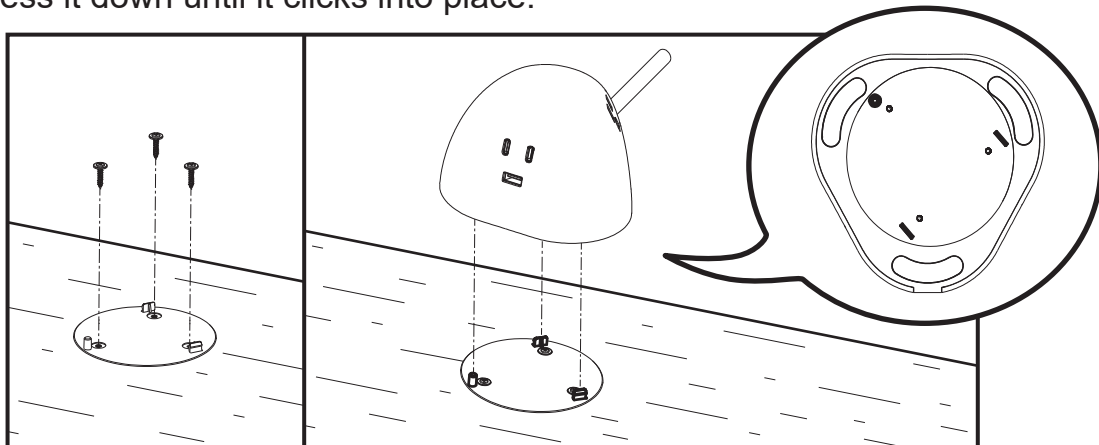

- b. Using three self-tapping screws(included) mount the lower dock under table at desired position.

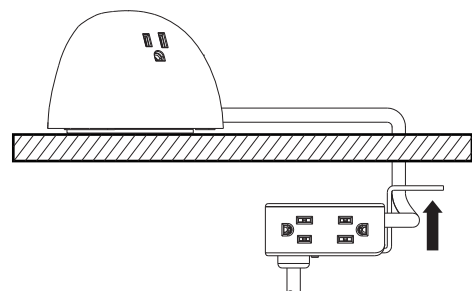

- c. Plug in the power cord to a nearest wall outlet. Do not use extension cord(s).

For further assistance, please contact National Lighting Corp. at +1(888) 428-6886