

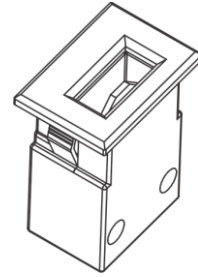

## INSTALLATION INSTRUCTIONS

For DOCK110 Series USB Chargers (electrical rating: DC 5V 2.1A)

**CAUTION:** To prevent the risk of fire and electric shock, please be sure to read all instructions before installing or using this unit.



### IMPORTANT SAFETY INSTRUCTIONS

**WARNING – To reduce the risk of fire, electric shock, or injury to persons:**

1. Use the unit for indoor only.
2. Do not use extension cord(s) that is not supplied by National Lighting to connect the unit(s).
3. Do not try to open the unit for any reason.

### MOUNTING

#### SURFACE-MOUNT (for models shipped with the mounting bracket)

1. Place the mounting bracket on the desired surface and use three screws (included) to fasten it onto the wood surface.
2. Set the charger on the mounting bracket and push it in until it is locked in place.
3. Connect the input cord to the input jack in the back of the DOCK110.
4. Connect the USB end of the input cord to the power adapter.

#### RECESS-MOUNT

1. Cut a 0.807" x 0.610" (20.5 mm X 15.5 mm) rectangle hole on the mounting surface. Or route a hole using the specifications from the illustrations on the right.
2. Push the charger through the hole until it is locked in place.
3. Connect the input cord to the input jack in the back of the DOCK110.
4. Connect the USB end of the input cord to the power adapter.

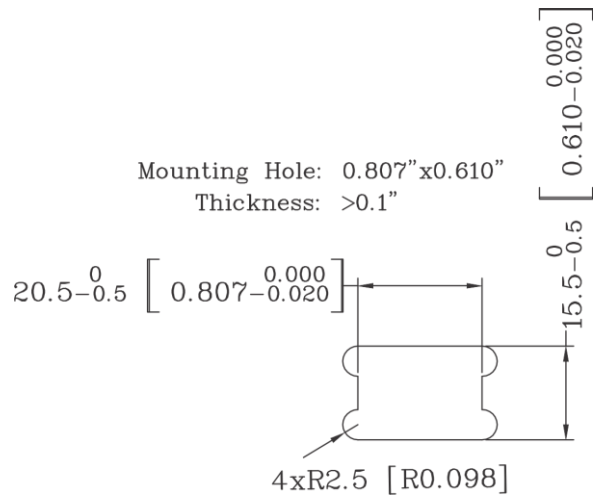

### USING THIS USB CHARGER

1. Plug the power adapter to nearest wall outlet.
2. Connect the USB type A connector from the mobile device to the charger. The total charging power cannot exceed DC 5V, 2.1A (approx. 10W).

Please contact with National Lighting Corp. at (562) 921-0056 for assistance if any question occurs during installation.