

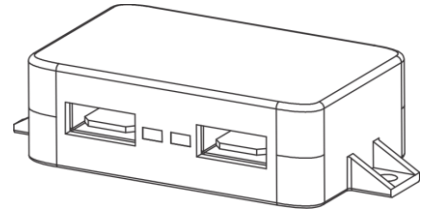

INSTALLATION INSTRUCTIONS

For DOCK120 Series USB Chargers (electrical rating: DC 5V 4.2A)

CAUTION: To prevent the risk of fire and electric shock, please be sure to read all instructions before installing or using this unit.



IMPORTANT SAFETY INSTRUCTIONS

WARNING – To reduce the risk of fire, electric shock, or injury to persons:

1. Use the unit for indoor only.
2. Do not use extension cord(s) that is not supplied by National Lighting to connect the unit(s).
3. Do not try to open the unit for any reason.

MOUNTING

SURFACE-MOUNT

1. Place the charger on the desired surface and use two screws (included) to fasten it onto the wood surface.
2. Connect the input cord to the input jack in the back of the DOCK120.
3. DOCK120 can be daisy-chained up to two units per wiring branch. Use the other jack in the back of the DOCK120 to connect two units together.

USING THIS USB CHARGER

1. Plug the power adapter to nearest wall outlet.
2. Connect the USB type A connector from the mobile device to the charger. The charging power per port cannot exceed DC 5V, 2.1A (approx. 10W).
3. The green indicator lights up when charging.

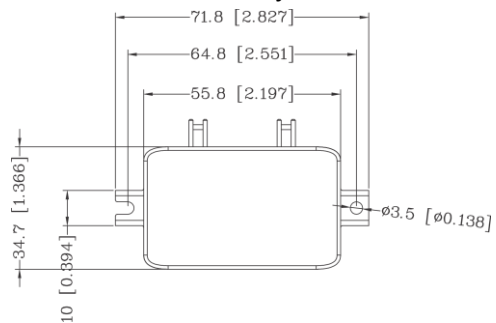

Please contact with National Lighting Corp. at (562) 921-0056 for assistance if any question occurs during installation.