

LED TABLE LAMP SERIES - TL-3000

Specifications & Features

- Product Name: LED table lamp
- Model# TL-3000
- Light Source: Side-emitted LED panel
- Lumen Output: 960 lumen max.
- Color Temperature: 3,300K - 6,200K (4 preset modes)
- Dimming: 5 levels
- Glare, flicker, shadow and UV free
- Built-in USB charger for mobile devices
- Adjustable arm for maximized light coverage
- Power input: AC 100-240V power adapter with DC 12V 2A output
- Dimensions: 7.09" X 6.74" X 17.92"



Control Panel

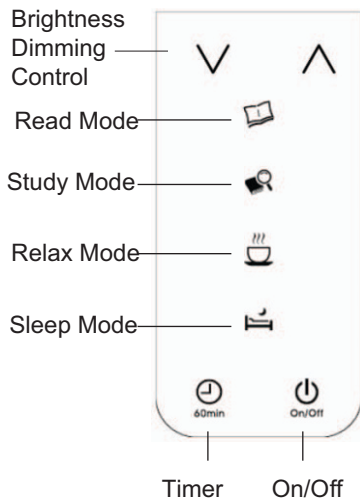

Brightness Control

5-step brightness dimming control

Operating Modes

Read Mode (5,300K)



A good mixture of white and warm white lights stimulates concentration and reduces eye strains

Study Mode (6,200K)



High color temperature output helps user stays focus and alert when working on important tasks.

Relax Mode (4,200K)



Promotes relaxation along with improved mood and the choice of low-range color temperature.

Sleep Mode (3,300K)



Encourage a deep sleep with the comfort of soft/ warm light.

Timer Control Function



Automatically turns-off the light in one (1) hour

One Touch Control Function



Power On/Off the table lamp

USB Power Charging Port

The USB port supplies DC 5V output up to 700 mA for charging mobile devices that is capable of USB charging.

Assembly Instructions

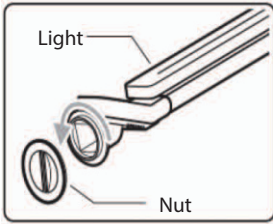

Step 1

Unscrew and remove the nut from the light

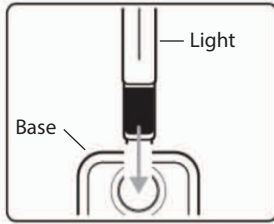

Insert the light into the round hole on the base

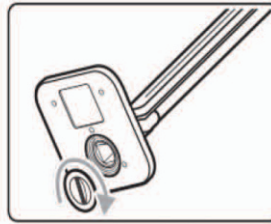

Step 3

Tighten the nut by turning it clockwise

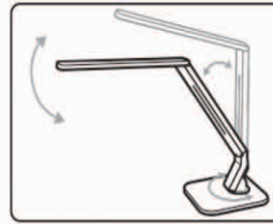

Step 4

Adjust the lamp to the desired position.

Adjustments

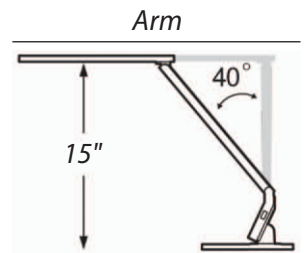

Head

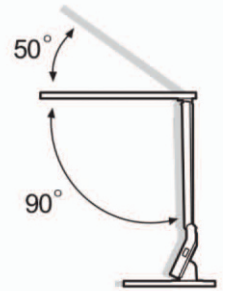

Base

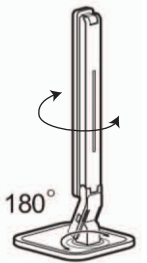

Operation Instructions



Control Panel

Select the desired lighting mode by touching the correspond icon.

Adjust the brightness level by touching up or down arrow.



USB Charging Port

Step 1a

Plug the USB cable into the USB charging port and connect the mobile device to the other end of the USB cable.



Step 1b

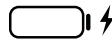

Charging icon on the mobile device should appear showing it is charging (icon may vary depending on device)

Cautions



Do not try to repair, disassemble or modify this unit under any circumstances.

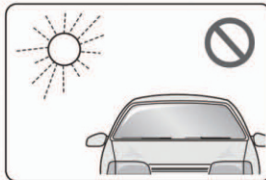

Do not place the unit near any heat source or under direct sunlight.



Place on flat, secured surfaces.



Use only with the supplied AC/DC power adaptor

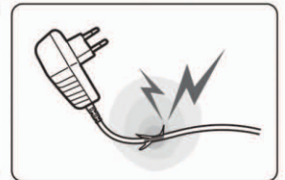

Stop using the unit immediately when the power supply cord is damaged.



Do not touch any part of this unit with wet hands or when liquids are present.



Please keep the unit dry and clean at all times.

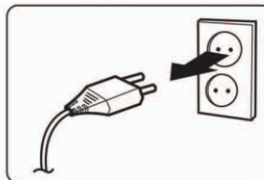

Unplug the unit from wall outlet when it is not planned to be used for an extended period of time.



Use a soft, dry cloth to clean the unit. Do not use solvents or cleaning solutions.

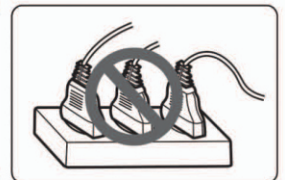

Do not overload electrical circuits as it may cause electrical shock or fire hazards.